

PRINTABLE INFO SHEET

Series: Eastland Concepts
 Singlewides
 Model: A12008-P

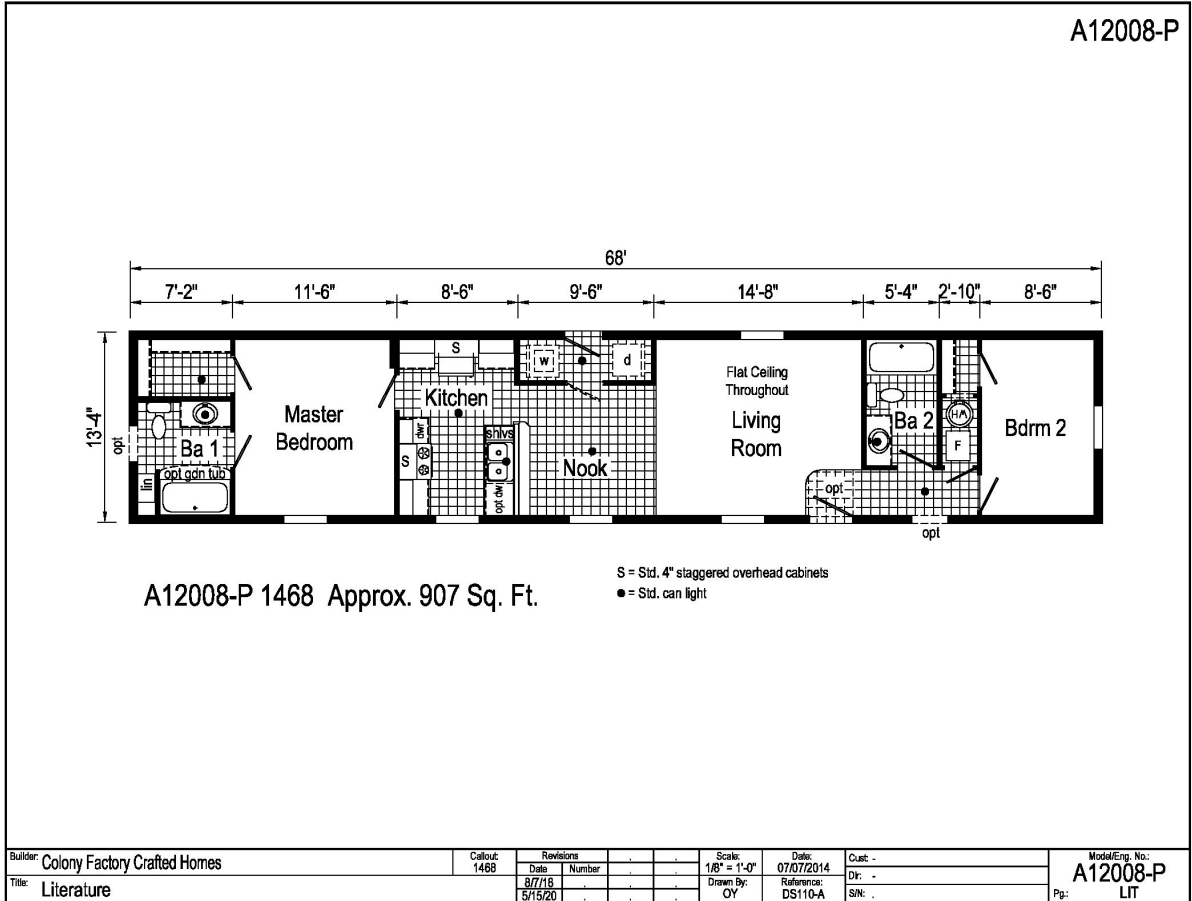

About This Model

Style: Single / Bedrooms: 2 / Bathrooms: 2 / Square Feet: 907

CUSTOMER CONTACT

Notes: _____

PRINTABLE INFO SHEET

Series: Eastland Concepts
Singlewides
Model: A12008-P



Standards & Features

INTERIOR

- Flat Ceiling Throughout
- Stipple Ceiling
- 8' Sidewall Height
- Vinyl Wall Coverings on Gypsum Walls
- LED Flush Mount Ceiling Lights
- Pre-Hung Door Jambs
- Mortise Hinges
- Metal Interior Passage Sets
- Floor Mount Door Stops
- Smoke Detectors With Battery Back-Up
- Wire Shelving in Guest Closet
- Window Treatments
- 2" Mini Blinds Throughout
- White 2-Panel Passage Doors

EXTERIOR

- Gatsby Light - Front & Rear Door
- One GFI-Protected Exterior Receptacle
- Vinyl Dutch Lap Siding
- Sheathing Board Under Siding
- Shingle Roof with
- 4" Eaves & Single Section (14/16)
- 10" Eaves & Ranch Homes (28/32)
- 12" Gable End Overhang
- Ridgevent Roof Ventilation System
- 38x82 Fiberglass 6-Panel Front Door
- 34x82 Fiberglass 6-Panel Rear Door
- Schlage Exterior Locksets Keyed Alike
- Mulled Vinyl Insulated Windows w/Grids

EXTERIOR (continued)

- 15" Raised Panel Shutters on Front Door Side

CONSTRUCTION

- 2x6 Transverse Floor & 12/14 wide
- 2x8 Transverse Floor & 16 wide
- 2x6 Exterior Walls on 16" Centers**
- 3/4" T&G OSB Floor Decking
- 20# Roof Load
- Recessed Frame Design

KITCHEN

- 30" Deluxe Black Gas Range
- Power Range Hood with Light
- 18 Cubic Foot Black, No-Frost Refrigerator
- Stainless Steel Sink - 33x22x8
- Structure Flow Single Lever w/ Sprayer Faucet
- 1 USB Receptacle

BATHS

- 60" Fiberglass Tub/Showers
- 1.6 Gallon Per Flush Elongated Toilets
- China Stool, Tank and Lid
- Lighted Vent Fan in Each Bath
- Empire Faucets
- Anti-Scald Faucets in Tub/Shower
- Shower Drain with Removable Strainer
- Square China Lav
- Furniture Style Lav

CABINETRY

- Evermore Custom Cabinetry (KCMA Certified)

CUSTOMER CONTACT

Notes:

PRINTABLE INFO SHEET

Series: Eastland Concepts
Singlewides
Model: A12008-P



Standards & Features (continued)

CABINETRY (continued)

MDF Mission Style Cabinet Doors
Brushed Nickel Cabinet Hardware
Contemporary Crown Moulding on Kitchen Cabinets
Lined Overhead Cabinets
30" Staggered Height Overhead Cabinets
Laminate Countertops
Laminate Backsplashes
Concealed Cabinet Hinges
Soft Close Drawer Guides
Dovetail Drawers
Base and Center Shelves in Base Cabinets
Base Shelf in Vanities
36" High Bath Vanities

UTILITIES

Plumbed and Wired for Washer
Vented and Wired for Dryer
100 AMP Electrical Service w/ Extended Panel
30 Gallon Electric Water Heater with Pan
Gas Furnace
White 2-Panel Door w/Grill
Air Exchanger System for Furnace
Aluminum Heat Ducts
Perimeter Heat
In-Floor Cross-Over Heating System
Copper Wiring Throughout
Main Water Line Shut-Off Valve

UTILITIES (continued)

Programmable Thermostat

FLOORING

Choice of Various Styles of Textured Carpet:
-Standard Shaw Take Away
-Upgrade Styles Available
Rebond Carpet Pad with Tackstrip
Carpet Installation
Shaw Fortress & Vinyl Floor Coverings

BEDROOMS

Switched Light Each Bedroom (LED)
Vinyl Wall Coverings in all Bedrooms
Egress Window Each Bedroom
Wire Shelving in Wardrobes
Switched Light in All Walk-In Closets

INSULATION

R-14 Fiberglass in Floor
R-19 Fiberglass in Walls
R-25 Avg. Blown in Ceiling -Single
R-28 Avg. Blown in Ceiling & Ranch

CUSTOMER CONTACT

Notes:
