

PRINTABLE INFO SHEET

Series: Eastland Concepts
 Singlewides
 Model: A12003-P

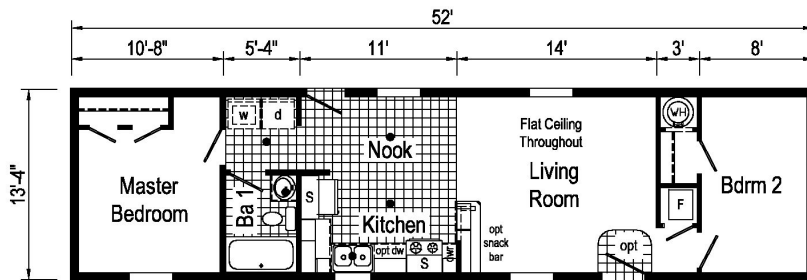

A12003-P



A12003-P 1452 Approx . 693 Sq. Ft.

S = Std. 4" staggered overhead cabinets
 ● = Std. can light

Builder: Colony Factory Crafted Homes	Callout: 1452	Revisions	Scale: 1/8" = 1'-0"	Date: 6/4/18	Client: -	Model/Eng. No.: A12003-P
Title: Literature		Date / Number	Drawn By: OY	Reference: A4136-A	Dir: -	Pg: LIT
		8/7/18 / 5/15/20				

About This Model

Style: Single / Bedrooms: 2 / Bathrooms: 1 / Square Feet: 693

CUSTOMER CONTACT

Notes: _____

PRINTABLE INFO SHEET



Series: Eastland Concepts
Singlewides
Model: A12003-P

Standards & Features

INTERIOR

- Flat Ceiling Throughout
- Stipple Ceiling
- 8' Sidewall Height
- Vinyl Wall Coverings on Gypsum Walls
- LED Flush Mount Ceiling Lights
- Pre-Hung Door Jambs
- Mortise Hinges
- Metal Interior Passage Sets
- Floor Mount Door Stops
- Smoke Detectors With Battery Back-Up
- Wire Shelving in Guest Closet
- Window Treatments
- 2" Mini Blinds Throughout
- White 2-Panel Passage Doors

EXTERIOR

- Gatsby Light - Front & Rear Door
- One GFI-Protected Exterior Receptacle
- Vinyl Dutch Lap Siding
- Sheathing Board Under Siding
- Shingle Roof with
- 4" Eaves & Single Section (14/16)
- 10" Eaves & Ranch Homes (28/32)
- 12" Gable End Overhang
- Ridgevent Roof Ventilation System
- 38x82 Fiberglass 6-Panel Front Door
- 34x82 Fiberglass 6-Panel Rear Door
- Schlage Exterior Locksets Keyed Alike
- Mulled Vinyl Insulated Windows w/Grids

EXTERIOR (continued)

- 15" Raised Panel Shutters on Front Door Side

CONSTRUCTION

- 2x6 Transverse Floor & 12/14 wide
- 2x8 Transverse Floor & 16 wide
- 2x6 Exterior Walls on 16" Centers**
- 3/4" T&G OSB Floor Decking
- 20# Roof Load
- Recessed Frame Design

KITCHEN

- 30" Deluxe Black Gas Range
- Power Range Hood with Light
- 18 Cubic Foot Black, No-Frost Refrigerator
- Stainless Steel Sink - 33x22x8
- Structure Flow Single Lever w/ Sprayer Faucet
- 1 USB Receptacle

BATHS

- 60" Fiberglass Tub/Showers
- 1.6 Gallon Per Flush Elongated Toilets
- China Stool, Tank and Lid
- Lighted Vent Fan in Each Bath
- Empire Faucets
- Anti-Scald Faucets in Tub/Shower
- Shower Drain with Removable Strainer
- Square China Lav
- Furniture Style Lav

CABINETRY

- Evermore Custom Cabinetry (KCMA Certified)

CUSTOMER CONTACT

Notes:

PRINTABLE INFO SHEET



Series: Eastland Concepts
Singlewides
Model: A12003-P

Standards & Features (continued)

CABINETRY (continued)

- MDF Mission Style Cabinet Doors
- Brushed Nickel Cabinet Hardware
- Contemporary Crown Moulding on Kitchen Cabinets
- Lined Overhead Cabinets
- 30" Staggered Height Overhead Cabinets
- Laminate Countertops
- Laminate Backsplashes
- Concealed Cabinet Hinges
- Soft Close Drawer Guides
- Dovetail Drawers
- Base and Center Shelves in Base Cabinets
- Base Shelf in Vanities
- 36" High Bath Vanities

UTILITIES

- Plumbed and Wired for Washer
- Vented and Wired for Dryer
- 100 AMP Electrical Service w/ Extended Panel
- 30 Gallon Electric Water Heater with Pan
- Gas Furnace
- White 2-Panel Door w/Grill
- Air Exchanger System for Furnace
- Aluminum Heat Ducts
- Perimeter Heat
- In-Floor Cross-Over Heating System
- Copper Wiring Throughout
- Main Water Line Shut-Off Valve

UTILITIES (continued)

- Programmable Thermostat

FLOORING

- Choice of Various Styles of Textured Carpet:
- Standard Shaw Take Away
- Upgrade Styles Available
- Rebond Carpet Pad with Tackstrip
- Carpet Installation
- Shaw Fortress & Vinyl Floor Coverings

BEDROOMS

- Switched Light Each Bedroom (LED)
- Vinyl Wall Coverings in all Bedrooms
- Egress Window Each Bedroom
- Wire Shelving in Wardrobes
- Switched Light in All Walk-In Closets

INSULATION

- R-14 Fiberglass in Floor
- R-19 Fiberglass in Walls
- R-25 Avg. Blown in Ceiling -Single
- R-28 Avg. Blown in Ceiling & Ranch

CUSTOMER CONTACT

Notes:
