

PRINTABLE INFO SHEET

Series: Beacon Primo
Model: DT1302-P Beacon Primo

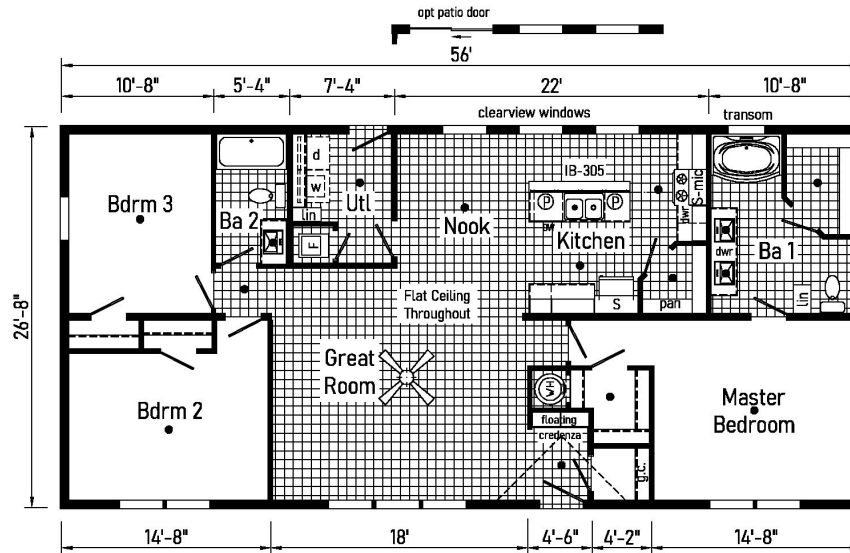

DT1302-P 2856 Approx. 1493 Sq. Ft.

Beacon Primo

- = Std. can light
- S = Std. 4" staggered overhead cabinets
- Ⓟ = Std. pendant light

Builder: Colony Factory Crafted Homes	Callout: 2856	Revisions:	Scale: 1/8" = 1'-0"	Date: 6/29/22	Cust.:	Model/Eng. No.: DT1302-P
Title: Literature		Drawn By: OY	Reference: NONE	Dir.:	S/N: ----	LIT

About This Model

Style: Ranch / **Bedrooms:** 3 / **Bathrooms:** 2 / **Square Feet:** 1493

CUSTOMER CONTACT

Notes:

PRINTABLE INFO SHEET

Series: Beacon Primo
Model: DT1302-P Beacon Primo



Standards & Features

INTERIOR

Flat Ceiling Throughout
Stipple Ceiling
8' Sidewall Height
Vinyl Wall Coverings on Gypsum
LED Flush Mount Ceiling Lights per print
Ceiling Fan in Living Room
Pre-Hung Door Jambs
Mortise Hinges
Metal Interior Passage Sets
Floor Mount Door Stops
Smoke Detectors With Battery
Back-Up
Wire Shelving in Guest Closet
Wire Shelf over Washer/Dryer Hookup
2" Mini Blinds Throughout
White 6-Panel Passage Doors

EXTERIOR

Patina Square Light at Front Door
Seeded Glass Light at Rear Door
One GFI-Protected Exterior Receptacle
Two Exterior Water Faucets
Vinyl Dutch Lap Siding
Sheathing Board Under Siding
Shingle Roof with
4" Eaves – Single Section (14/16)
10" Eaves – Ranch Homes (28/32)
12" Gable End Overhang
Ridgevent Roof Ventilation System
38x82 Steel 6-Panel Front Door
38x82 9-Lite Rear Door

EXTERIOR (continued)

Schlage Exterior Locksets Keyed Alike
Vinyl Insulated Windows with Grids
12" Raised Panel Shutters on Front
Door Side

CONSTRUCTION

2x6 Transverse Floor – 12/14 wide
2x8 Transverse Floor – 16 wide
2x6 Exterior Walls on 16" Centers**
¾" T&G OSB Floor Decking
20# Roof Load
Recessed Frame Design
(2) Adjustable Outriggers

KITCHEN

30" Deluxe Stainless Steel Elec Range
Stainless Steel Over Range Microwave
Stainless Steel Dishwasher - 4 Cycle
20 cu ft Stainless Steel Refrigerator
Stainless Steel Sink - 33x19x7
Structured Flow Hi-Rise Faucet
1 USB Receptacle
Kitchen Island
(2) Cylindrical Pendant Lights at Island

BATHS

Fiberglass Garden Tub at Master Bath
60" Fiberglass Tub/Showers - Bath 2
1.6 Gallon Per Flush Elongated Toilets
China Stool, Tank and Lid
Lighted Vent Fan in Each Bath
Structured Flow Faucets
Square China Sinks

CUSTOMER CONTACT

Notes:

PRINTABLE INFO SHEET

Series: Beacon Primo
Model: DT1302-P Beacon Primo



Standards & Features (continued)

BATHS (continued)

Double Lav Sinks - Master Bath
Anti-Scald Faucets in Tub/Shower
Shower Drain w/ Removable Strainer

CABINETRY

KCMA Evermore Custom Cabinetry
MDF Mission Style Cabinet Doors
Brushed Nickel Cabinet Hardware
Lined Overhead Cabinets
30" Staggered Overhead Cabinets
Dovetail Drawers
Laminate Countertops
Laminate Backsplashes
Concealed Cabinet Hinges
Soft Close Drawer Guides
Base Shelves in Base Cabinets
Base Shelf in Vanities
36" High Bath Vanities

UTILITIES

Plumbed and Wired for Washer
Vented and Wired for Dryer
200 AMP Electrical Service
30 Gallon Electric Water Heater
with Pan
Electric Furnace
White 6-Panel Door w/Grill
Air Exchanger System for Furnace
Aluminum Heat Ducts
In-Floor Cross-Over Heating System
Copper Wiring Throughout
In House Main Water Line Shut-Off

UTILITIES (continued)

Water Shut Offs
Programmable Thermostat

FLOORING

Choice of Various Styles of Textured
Carpet:
-Standard Take Away Carpet
-Upgrade Styles Available
Rebond Carpet Pad with Tackstrip
Carpet Installation
DiamondFlor & Vinyl Floor Coverings
Vinyl Entry Foyer

BEDROOMS

Switched Receptacles
Vinyl Wall Coverings in all Bedrooms
Egress Window Each Bedroom
Wire Shelving in Wardrobes
Switched Light in All Walk-In Closets

INSULATION

R-14 Fiberglass in Floor
R-19 Fiberglass in Walls
R-25 Avg. Blown in Ceiling -Single
R-28 Avg. Blown in Ceiling & Ranch
**NOTE: Spacing for Framing Members may vary
due to Design Requirements

CUSTOMER CONTACT

Notes:
