

PRINTABLE INFO SHEET

Series: Beacon Prestige

Model: DT1006-P

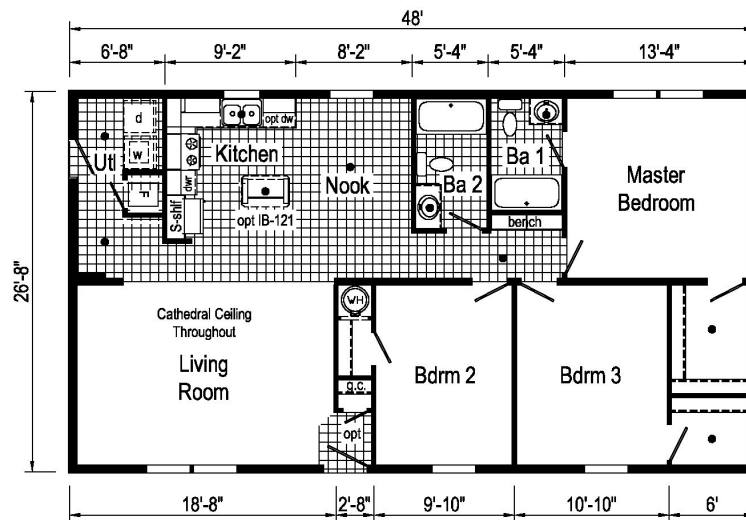

DT1006-P 2848 Approx. 1280 Sq. Ft.

S = Std. 4" staggered overhead cabinets
● = Std. can light

Builder: Colony Factory Crafted Homes	Callout: 2848	Revisions:	Scale: 1/8" = 1'-0"	Date: 7/18/19	Cost: -	Model/Eng. No.: DT1006-P
Title: Literature		Date: 7/19/19	Drawn By: OY	Reference: DT1503-P	Dir: -	Pg: LIT

About This Model

Style: Ranch / Bedrooms: 3 / Bathrooms: 2 / Square Feet: 1280

CUSTOMER CONTACT

Notes:

PRINTABLE INFO SHEET



Series: Beacon Prestige

Model: DT1006-P

Standards & Features

INTERIOR

Flat Ceiling Throughout - Single
Cathedral Ceiling Throughout -Ranch
Stipple Ceiling
8' Sidewall Height - Single
7'6" Sidewall Height - Ranch
Vinyl Wall Coverings on Gypsum
LED Flush Mount Ceiling Lights
Pre-Hung Door Jambs
Mortise Hinges
Metal Interior Passage Sets
Floor Mount Door Stops
Smoke Detectors With Battery
Back-Up
Wire Shelving in Guest Closet
2" Mini Blinds Throughout
White 6-Panel Passage Doors

EXTERIOR

Patina Square Light at Front Door
Seeded Glass Light at Rear Door
One GFI-Protected Exterior Receptacle
Vinyl Dutch Lap Siding
Sheathing Board Under Siding
Shingle Roof with
4" Eaves & Single Section (14/16)
10" Eaves & Ranch Homes (28/32)
12" Gable End Overhang
Ridgevent Roof Ventilation System
38x82 Steel 6-Panel Front Door
34x82 6-Panel Rear Door
Schlage Exterior Locksets Keyed Alike

EXTERIOR (continued)

Vinyl Insulated Windows with Grids
12" Raised Panel Shutters on Front
Door Side

CONSTRUCTION

2x6 Transverse Floor & 12/14 wide
2x8 Transverse Floor & 16 wide
2x6 Exterior Walls on 16" Centers**
¾" T&G OSB Floor Decking
20# Roof Load
Recessed Frame Design

KITCHEN

30" Deluxe Black Gas Range
Power Range Hood with Light
18 Cubic Foot Black, No-Frost Refrigerator
Stainless Steel Sink - 33x19x7
Empire Hi-Rise Faucet
1 USB Receptacle

BATHS

60" Tub/Showers
1.6 Gallon Per Flush Elongated Toilets
China Stool, Tank and Lid
Lighted Vent Fan in Each Bath
Empire Faucets
Anti-Scald Faucets in Tub/Shower
Shower Drain w/ Removable Strainer

CABINETRY

KCMA Evermore Custom Cabinetry
MDF Mission Style Cabinet Doors
Brushed Nickel Cabinet Hardware
Lined Overhead Cabinets

CUSTOMER CONTACT

Notes:

PRINTABLE INFO SHEET



Series: Beacon Prestige

Model: DT1006-P

Standards & Features (continued)

CABINETRY (continued)

30" Staggered Overhead Cabinets
Dovetail Drawers
Laminate Countertops
Laminate Backsplashes
Concealed Cabinet Hinges
Soft Close Drawer Guides
Base Shelves in Base Cabinets
Base Shelf in Vanities
36" High Bath Vanities

UTILITIES

Plumbed and Wired for Washer
Vented and Wired for Dryer
200 AMP Electrical Service
30 Gallon Electric Water Heater
with Pan
Electric Furnace
White 6-Panel Door w/Grill
Air Exchanger System for Furnace
Aluminum Heat Ducts
In-Floor Cross-Over Heating System
Copper Wiring Throughout
Main Water Line Shut-Off Valve
Programmable Thermostat

FLOORING

Choice of Various Styles of Textured
Carpet:
-Standard 18 oz. Lucerne/Innovations
-Upgrade Styles Available
Rebond Carpet Pad with Tackstrip
Carpet Installation

FLOORING (continued)

DiamondFlor & Vinyl Floor Coverings

BEDROOMS

Switched Receptacles
Vinyl Wall Coverings in all Bedrooms
Egress Window Each Bedroom
Wire Shelving in Wardrobes
Switched Light in All Walk-In Closets

INSULATION

R-14 Fiberglass in Floor
R-19 Fiberglass in Walls
R-25 Avg. Blown in Ceiling -Single
R-28 Avg. Blown in Ceiling & Ranch

CUSTOMER CONTACT

Notes:
